



# SOUNDSCAPES CANOPIES



## BENEFITS

- Enhance acoustics with spot absorption
- Aesthetically define spaces and enhance acoustic in open plenum spaces with spot sound absorption
- Curved panels can be used as 'Hill' or 'Valley'
- Six standard colors; custom colors available
- Adjustable to special heights
- Energy-efficient, high light-reflectant surface
- Easy to use hardware system for fast & easy installation
- Color co-ordinate with SoundScapes shapes

## BENEFITS

- Board Rooms
- Hotel Lobbies
- Office Spaces
- Breakout Spaces
- Auditoriums
- Shopping Malls



## COLOR SELECTION



Traffic White  
RAL9016



Light Ivory  
RAL1015



Pale Green  
RAL6021



Pastel Blue  
RAL5024



Traffic Grey  
RAL7042



Pale Brown  
RAL8025

NOTE: Special care in installation and handling must be taken with color canopies to avoid surface damage to the paint finish.

\*Due to printing limitations, shades may vary from actual product.

## DETAIL



Matching paint finish  
on all sides and edges

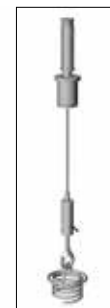

Embedded hardware  
in back of panel

# ACOUSTICAL PERFORMANCE

## Sound Absorption in Sabin

The Sabin is the unit of total sound absorption provided by an object. This is the preferred metric for “space absorbers” such as clouds, canopies or baffles installed within an architectural space. Total acoustical absorption for a suspended ceiling is calculated by multiplying the exposed surface area by the material NRC while “space absorbers” are directly measured. SoundScapes Acoustical Canopies provide greater sound absorption than a continuous ceiling of the same surface area because the sound is absorbed from both the front and back surfaces. The installation of canopies in a reverberant space

can significantly reduce the background noise and reverberation time, enhancing speech intelligibility.

Factors that may affect the installed acoustical performance relative to the published results are:

- Size and shape of canopy
- Number of canopies and their layout/location
- Suspension distance below exposed deck or finished ceiling

**EXPOSED STRUCTURE**

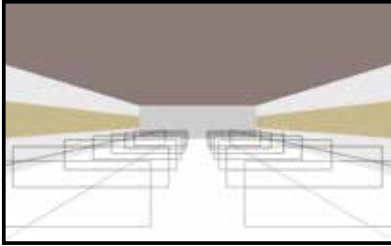

**25% SOUNDSCAPES CANOPIES**

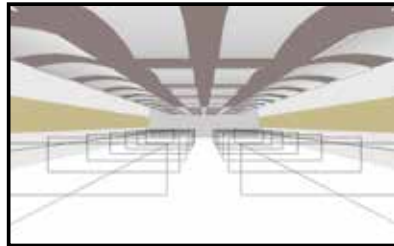

**50% SOUNDSCAPES CANOPIES**

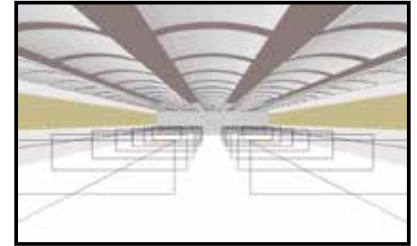

5,000 SF Exposed Structure (15240 x 30480mm), 4572mm to deck, drywall with windows two sides, commercial carpet

Acoustic Solution	None	SoundScapes Canopies @25% of ceiling	SoundScapes Canopies @50% of ceiling
	Exposed Structure	50 Canopies (1869x180mm)	100 Canopies (1869x180mm)
Reverberation Time (Sec)	3.4	1.5	0.9
RT reduction (%)	ref	57%	73%
SPL reduction (dB)	ref	-3 dB	-4 dB
Sound Absorption in Sabin (metric) for Coverage Area	ref	50 canopies @ 2.44 Sabin/panel = 122 Sabin	100 canopies @ 2.44 Sabin/panel = 122 Sabin

## KIT COMPONENTS

- Pre-curved SoundScapes Canopies
- Hardware and aircraft cables included



Cable Adjuster

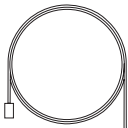

Aircraft Cable







Locking Gate Hook



Spiral Anchor

## PANEL SELECTION

Item No.*	Description		Dimension (mm)			Sabins/Panel
			Length	Width	Thickness	
GW600WCURVE 1870118030S		Large Hill	1870	1180	30	37.84
		Large Valley	1870	1180	30	37.84
GW600WCURVE 92591530S		Small Hill	925	915	30	14.5
		Small Valley	925	915	30	14.5

Item No.	Description
BP5450	Deck Hanging kit (Cable Adjuster+Aircraft Cable+Locking Gate Hook+Spiral Anchor)
BP7006BK	Escutcheon Kit – Used when hanging canopy below an existing ceiling; 2 kits needed per canopies panel.

## SUSPENSION SYSTEM DETAIL

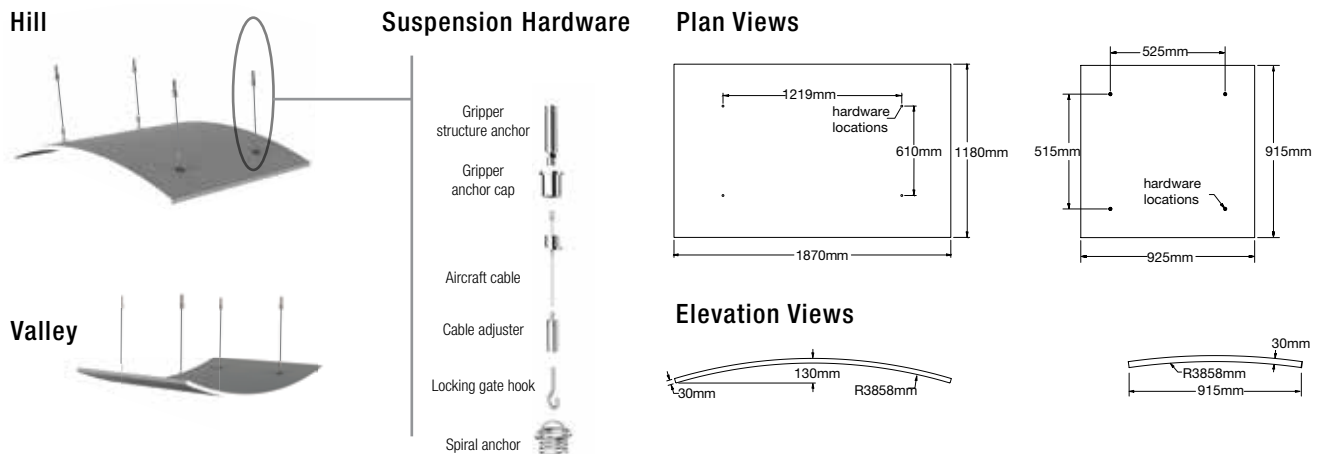

## PHYSICAL DATA

### Material

Curved canopy 30mm thick fiberglass with scrim on face and back, painted sides.

### Surface Finish

Scrim with factory-applied paint on face and back, painted sides. Standard White has energy-saving, high light-reflective finish (LR 0.90).

### Design Considerations

Special care in installation & handling must be taken to avoid surface damage to the paint finish. Due to slight thickness and paint system variations, do not mix SoundScapes Canopies with other SoundScapes products.

### Fire Performance

Class A as per ASTM E-84

### Acoustical Performance

Acoustical performance differs based on panel size. Refer chart on page 3 for more information.

### Recommended Suspension Systems

SoundScapes Canopies ships with the recommended installation components.

### Panel Weight

Large Canopy - 23 Kgs./Panel  
Small Canopy - 8.5 Kgs./Panel

### Warranty

One (1) year limited warranty.

## CONTACT US

### Knauf Ceiling Solutions (India) Private Limited

Boomerang, A-304, Chandivali Farm Road (near Chandivali Studio) Andheri (E), Mumbai - 400 072.

Contact us: 1860 266 7080 | e-mail: Helpdeskindia@knaufarmstrong.com

