



WOODWORKS CHANNELED PLANKS



BENEFITS

- Moisture resistant core for better post installation dimension stability
- Enables designers to create rich and warm interiors
- Easy to install on Wall & Ceiling
- Enhanced acoustical properties with 'Helmholtz Resonator' concept
- Transition from Wall to Ceiling
- Coated for a satin finish
- Improved acoustics with SoundTex® fleece

APPLICATION AREAS

- Atriums/Lobby
- Theatres and Auditoriums
- Home Theatres/Sound rooms
- Conference Room
- Office
- Commercial Spaces

DETAIL

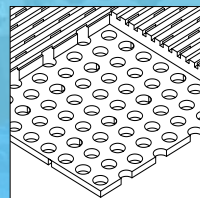

Helmholtz Resonator



COLOR SELECTION#

Laminated



Portland Maple
(10077)



Sea Beech
(10122)



Siam Wood
(10856)



Mystique Walnut
(10511)

Solid Color

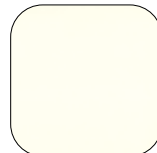

Interior White
(21341)

#Due to printing limitations, shade/color may vary from actual product.

Note:

- Contact your local Armstrong representative for more details.
- Shade variation among panels may occur for different batches of the same product

PRODUCT SELECTION

EDGE PROFILE

CHANNELED

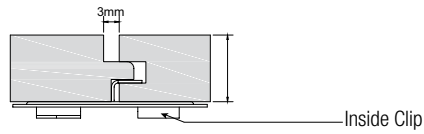

2400 x 192 x 15 mm

PERFORMANCE SELECTION



SOUND ABSORPTION

Is the control of reflected sound, provided by the surface within a space

PERFORATIONS

NRC

FREQUENCY (Hz)

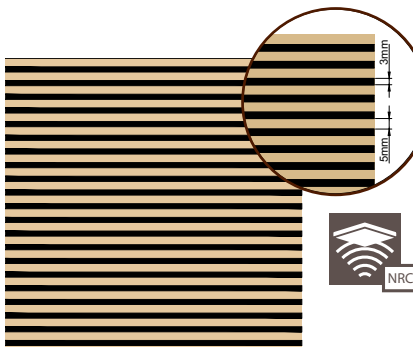

Lv1012 (G-5)

- Installation with 50mm air gap
- Installation with 50mm air gap & 50mm glasswool*
- Installation with 300mm air gap
- Installation with 300mm air gap & 50mm glasswool*

NRC	125	250	500	1000	2000	4000 Hz	
0.65	0.10	0.30	0.65	0.85	0.70	0.60	α_p ●
0.85	0.10	0.85	0.85	0.85	0.80	0.70	α_p ●
0.70	0.15	0.75	0.65	0.70	0.70	0.70	α_p ●
0.85	0.15	0.85	0.80	0.85	0.85	0.85	α_p ●

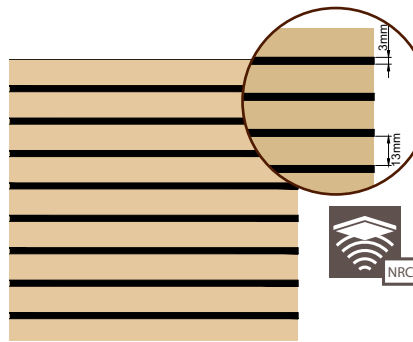
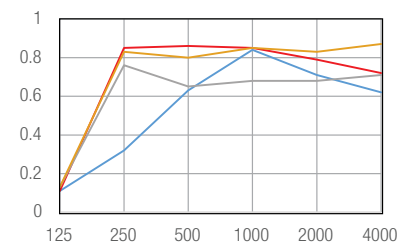

Lg1012 (G-13)

- Installation with 50mm air gap
- Installation with 50mm air gap & 50mm glasswool*
- Installation with 300mm air gap
- Installation with 300mm air gap & 50mm glasswool*

NRC	125	250	500	1000	2000	4000 Hz	
0.60	0.10	0.30	0.60	0.80	0.65	0.60	α_p ●
0.85	0.10	0.80	0.90	0.90	0.75	0.65	α_p ●
0.70	0.20	0.80	0.65	0.65	0.65	0.65	α_p ●
0.80	0.20	0.80	0.80	0.85	0.80	0.80	α_p ●

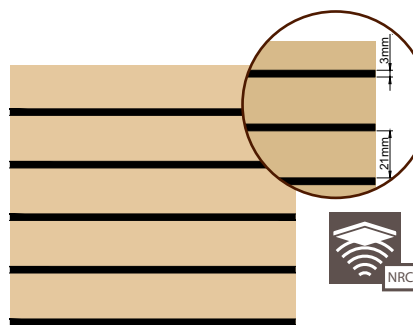
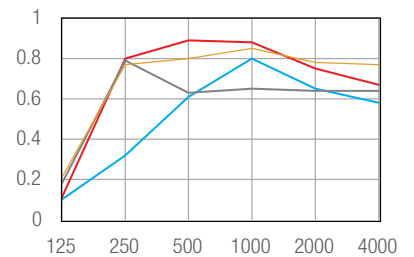

Lv1004 (G-21)

- Installation with 50mm air gap
- Installation with 50mm air gap & 50mm glasswool*
- Installation with 300mm air gap
- Installation with 300mm air gap & 50mm glasswool*

NRC	125	250	500	1000	2000	4000 Hz	
0.50	0.15	0.40	0.65	0.65	0.40	0.40	α_p ●
0.60	0.25	0.70	0.70	0.55	0.45	0.35	α_p ●
0.50	0.20	0.65	0.50	0.50	0.40	0.40	α_p ●
0.60	0.25	0.60	0.60	0.60	0.45	0.50	α_p ●

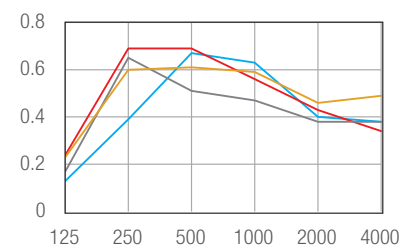

* Density of the Glasswool used for testing was 48 kgs/m³

* Density of the Glasswool used for testing was 48kgs/m³

Thickness tolerance +0.3mm / -0.7mm

PHYSICAL DATA

Material

Moisture resistant fibre board used as substrate

Surface Finish

Eggshell gloss/Suede

Design Considerations

5-6 cartons should be opened on site and mixed together before installation. They should be arranged aesthetically with regards to the shades and grains.

Application Consideration

Variation among panels may occur from batch to batch. It is very important that WoodWorks panels are climatized prior to installation. Relative humidity between 25% and 55%, and temperatures between 10°C and 30°C, must be maintained throughout the life of the product. The product is not suitable for exterior & semi exterior application.

Recommended Suspension Systems

Ceiling - Prelude 43 grid system with clips

Wall – Aluminum Keel with clips

Panel Weight

Panel Weight \cong 11kgs/m²

Warranty**

One (1) year limited warranty.

INSTALLATION OPTIONS AND DETAILS

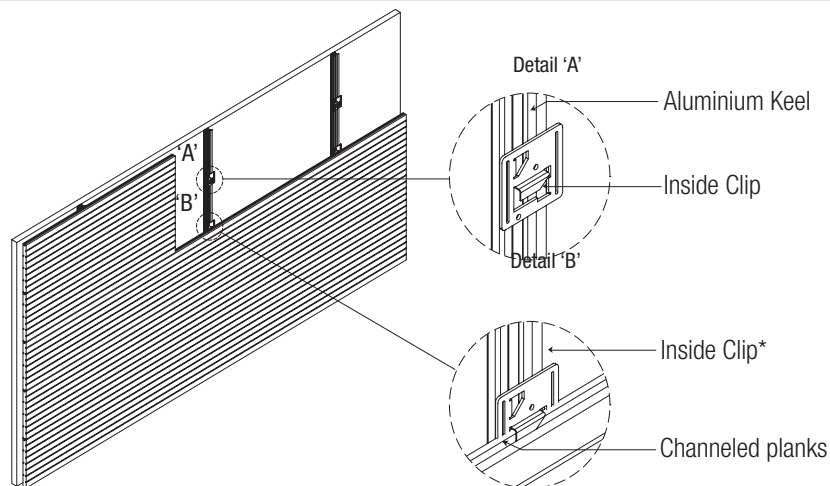

Inside Clip*

* Inside clips required for the purpose of installation would be present in the supplied cartons of channeled planks.

** Warranty stands void, if installed without Armstrong recommended suspension systems, accessories & procedure.

Product Development is an ongoing and continuous process. The products may vary from the images shown in this brochure.

Trim and Junction Accessories for WoodWorks Channeled

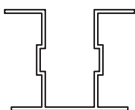

Aluminium Keel



Outside Corner Profile*

Note:- These images are for visual representation only and not as per scale

- Non-MR-Relative Humidity RH70%

- * These are optional accessories and to be ordered separately

WOODWORKS PROFILES



OUTSIDE PROFILE

A profile for outside corners to give a seamless transition to our WoodWorks Channeled Planks & Wooden Wall Panel. The profile is a finishing and edge protection profile for and is distinguished by a triangular reveal surface. The outside corner profile is to be installed with aluminum extruded corner spline for easy & quick installation.

Material: Laminated Vineer Lumbar (LVL)

Nominal Dimension: 3000 x 377 x 377 mm

Outside Corner -WWOTCORMLI

Extruded Aluminum Frame for Corner Spline -INDACORESPLINE



INSIDE CORNER

Specially crafted profile designed for inside wall corners to protect panel/plank edging and create a sleek, decorative finish. The Inside Corner Profiles are bonded to inside corners of existing panel/plank.

Material: Laminated Vineer Lumbar (LVL)

Nominal Dimension: 3000 x 15 x 15 mm Inside

Corner -WWIN MOLMLI



EDGE MOULDING

A trim designed to give your wooden planks & wall panels a stylish border or edging. This profile serves an important function by softening the raw edges of planks/panels to ensure proper installation.

Material: Laminated Vineer Lumbar (LVL)

Nominal Dimension: 3000 x 33 x 25 mm

Edge Molding -WWEDMOLMLI

WOODWORKS PROFILES INSTALLATION

OUTSIDE CORNER

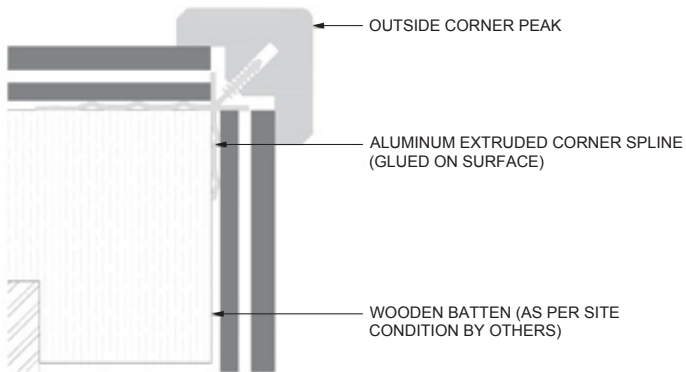

INSIDE CORNER

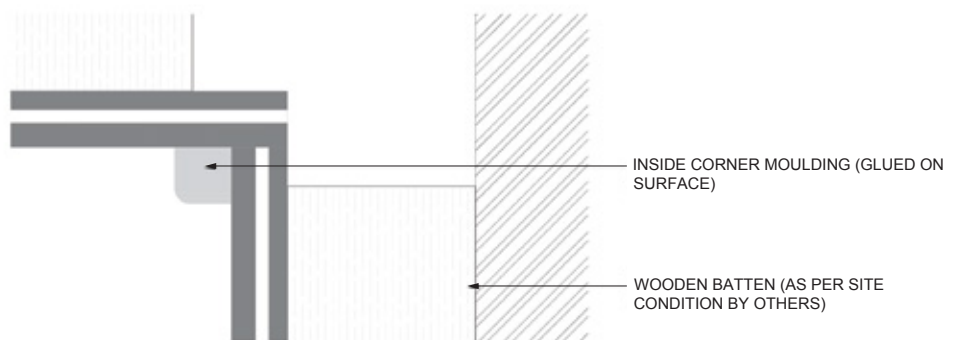

EDGE MOULDING

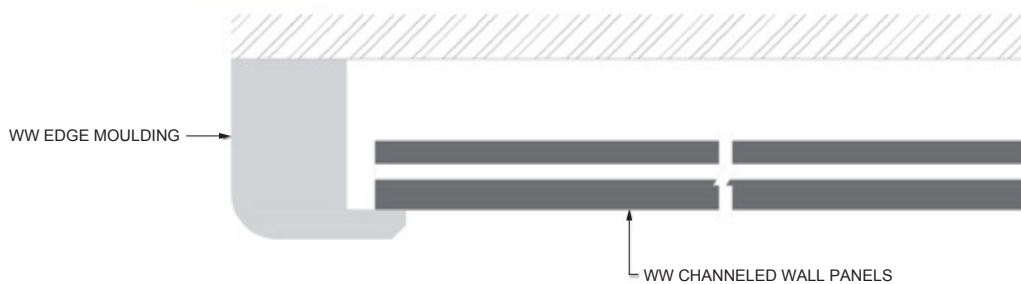

CONTACT US

Knauf Ceiling Solutions (India) Pvt. Ltd.

Boomerang, A-304, Chandivali Farm Road (near Chandivali Studio),
Andheri (E), Mumbai - 400 072.
e-mail : Helpdeskindia@knaufarmstrong.com

Contact us: 1860 266 7080



LA/500/092020