



**METALWORKS R-H 200  
HOOK ON PLANKS**



## BENEFITS

- Interior and exterior custom solutions in metal
- Choice of planks & curved canopies
- Panel dimension 300mm - 600mm in width & upto to 3000mm in length with a variety of other sizes available
- Recommended panel size ratio is maximum 1:2 (not ideal for 600mmx600mm)
- Most versatile custom system for metal plank design
- All panels are fully accessible without the use of tools
- Accessible system utilizes J-Bar suspension with rectangular hook-on (RH) panel
- 3mm reveal joint detail
- Factory cutouts available on request for recessed light and sprinklers

## APPLICATION AREAS

- Office
- Education
- Hospitality and retail
- Healthcare
- Transportation (including Light Rail)
- Exterior and Seismic application



## COLOR SELECTION



White  
(WH)



RAL colors#



Wood Grain  
Colors

## PERFORATION OPTIONS



Non Perforated



2.5 mm dia holes  
16% Open area



1.5 mm dia holes  
18% Open area



1.8 mm dia holes  
20% Open area

\*Due to printing limitations, shades color may vary from actual product.  
# Available on request

# ACCESSORIES

Item Number*	Description	Dimensions (mm)		
		Length	Width	Height
IND300026	J-Bar	4000	-	45
IND300343	J-Bar Splice	120	22	20
IND300307	J-Bar Hanger	-	40	47
IND300100M	U-Profile	3750	20	30
IND300119	U-Profile Splice	95	16.5	23
BPM300120	Plug-in clip	-	-	-
IND300140	Wall anchor	-	-	-
IND215013	Wall angle RA 4F	4000	25	25
BPM311081	Wall angle pressure spring	-	-	-
IND330056	J-Bar Security Clip (Exterior)	-	50	46
BPT19454	Wall angle 19X19	3000	19	19

\*When specifying or ordering, include the appropriate item number. Please calculate actual quantities, geometry, wastages and other considerations, these may vary from project to project.

## PANEL DETAIL

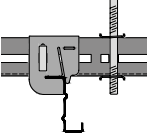
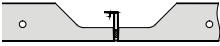
Grid Detail	Edge Detail	Item Description	Dimension	Perforations
		RH200 Hook On Panel with special Hook-on fall detail	Width upto 600 mm x Length upto 3000 mm	Non Perforated Standard Perforated Micro Perforated

## INSTALLATION DETAIL & EASE OF ACCESSIBILITY



Indiana University-Purdue University Indianapolis Campus Center

### PANEL INSTALLATION

Step 1.

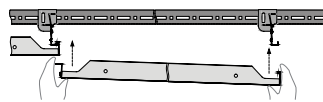

Step 2.

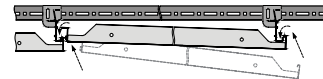

Step 3.

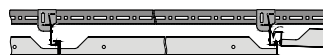

Step 4.



### PANEL

Step 1.

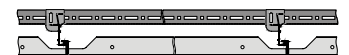

Step 2.

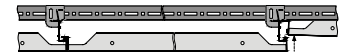

Step 3.

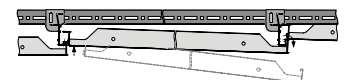

Step 4.

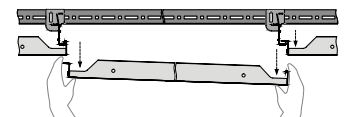

## PHYSICAL DATA

### Panel Dimensions

Typical panel dimension range from 300mm to 600mm wide upto 3000mm long. The RH200 system features larger size panels and gasketed 3mm joints. Our Armstrong Architectural Specialities project management team is available to assist in project design for custom Jobs.

### Material

Galvanized Steel - 0.6mm & 0.7mm  
Aluminum - 1.0mm

### Painted Finishes

Factory-applied polyester paint (interior),  
PVDF (exterior)

### Fire Performance

Class 0/Class 1 as per BS 476 – Part 6 & 7

### Acoustical Options

Perforated custom panels are usually supplied with, factory-installed black, sound absorbent acoustical fleece.

### Suspension Systems

Suspension is by means of a fully engineered J-Bar system. All panels are downward accessible without the use of tools. Security clamps may be installed if required. In this case, panels are accessible sequentially.

### Suspension Components:

- U-Profile
- U-Profile Splice
- Plug-in Clip
- J-Bar
- J-Bar Splice
- J-Bar Hanger
- J-Bar Security Clip
- Wall Anchor

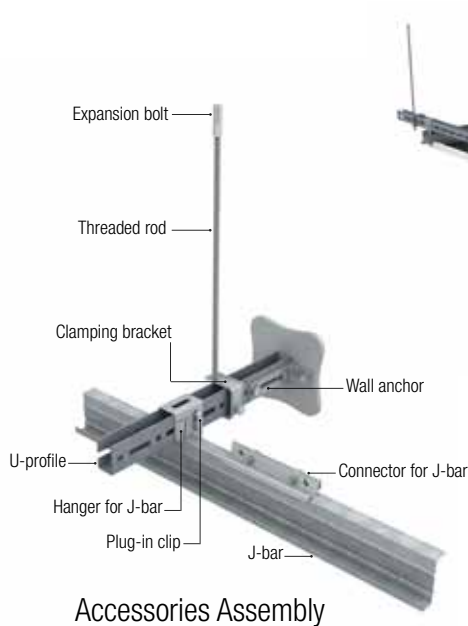

R-H 200 Hook on - System 3D



R-H 200 Hook on - Installed View

## CONTACT US

### Knauf Ceiling Solutions (India) Private Limited

(Formerly known as WAVE Suspension Systems India Pvt. Ltd.)

Boomerang, A-304, Chandivali Farm Road (near Chandivali Studio) Andheri (E), Mumbai - 400 072.

Tel : 022-6285 0800, Fax: 2491 3604 | e-mail : Helpdeskindia@knaufarmstrong.com

Contact: 1860 266 7080

### Branches:

Bengaluru	: +91-80 2657 6367	Chennai	: +91-44 4217 5303
Delhi	: +91-99 9989 1170	Hyderabad	: +91-40 6620 9368
Pune	: +91-84 1100 2914	Kolkata	: +91-93 3191 0333
Lucknow	: +91-84 0037 5375		

